

37 050 000 FLUSHING CISTERN FOR WC

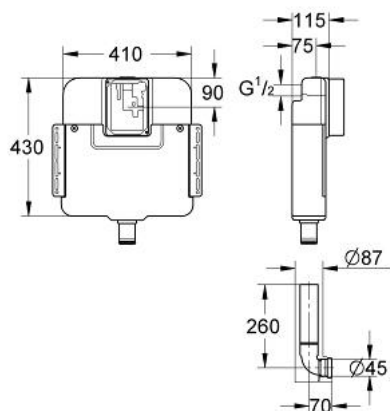

PRODUCT DESCRIPTION

- 6 l flush
- concealed installation
- interruptible flush
- made of polyethylene
- connection from top or back
- low noise (group I acc. to German Noise Specification)
- insulated against condensation
- 410 x 120 x 430 mm
- angle valve 1/2"
- fixing brackets
- flush pipe
- polystyrene protecting block 45 mm
- without wall plate/actuation
- GROHE Water Saving - Less water, perfect flow